



Barben BAC-100



(all dimensions - are in millimetres)

Cabinet Handles

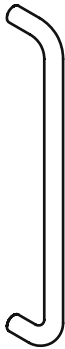

BAC-100/A	Dia. 10, Proj. 35, Length 85 ctc 75
BAC-100/B	Dia. 10, Proj. 35, Length 110 ctc 100
BAC-100/C	Dia. 10, Proj. 35, Length 135 ctc 125
BAC-100/D	Dia. 10, Proj. 35, Length 160 ctc 150
BAC-100/E	Dia. 10, Proj. 35, Length 210 ctc 200
BAC-100/F	Dia. 10, Proj. 35, Length 260 ctc 250
BAC-100/G	Dia. 10, Proj. 35, Length 310 ctc 300
BAC-100/H	Dia. 10, Proj. 35, Length 360 ctc 350
BAC-100/I	Dia. 10, Proj. 35, Length 410 ctc 400
BAC-100/J	Dia. 10, Proj. 35, Length 460 ctc 450
BAC-100/K	Dia. 10, Proj. 35, Length 510 ctc 500

... NEW PRODUCT 10-09-06 ...

Note: HANDLES can be Manufactured to Specific Requirements



Barben BAC-150

SSS

(all dimensions - are in millimetres)

Cabinet Handles

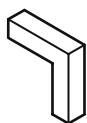

BAC-150/A Square 8, Proj. 30, Length 30



BAC-150/B Square 8, Proj. 30, Length 40 ctc 32

BAC-150/C Square 8, Proj. 30, Length 104 ctc 96

BAC-150/D Square 10, Proj. 30, Length 138 ctc 128

BAC-150/E Square 10, Proj. 30, Length 170 ctc 160

BAC-150/F Square 10, Proj. 30, Length 230 ctc 220

BAC-150/G Square 12, Proj. 30, Length 300 ctc 288

BAC-150/H Square 12, Proj. 30, Length 340 ctc 328

BAC-150/I Square 12, Proj. 30, Length 364 ctc 352

BAC-150/J Square 12, Proj. 30, Length 440 ctc 428

BAC-150/K Square 12, Proj. 30, Length 540 ctc 528

Note: HANDLES can be Manufactured to Specific Requirements



Barben BAC-157

SSS

(all dimensions - are in millimetres)

Cabinet Handles

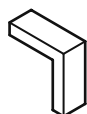

BAC-157/A Section 12x6, Proj. 30, Length 30

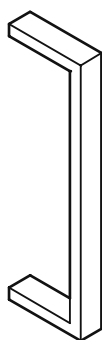

BAC-157/B Section 12x6, Proj. 30, Length 38 ctc 32

BAC-157/C Section 12x6, Proj. 30, Length 102 ctc 96

BAC-157/D Section 12x6, Proj. 30, Length 134 ctc 128

BAC-157/E Section 12x6, Proj. 30, Length 166 ctc 160

BAC-157/F Section 12x6, Proj. 30, Length 226 ctc 220

Note: HANDLES can be Manufactured to Specific Requirements

PSS Finish available for Projects Only

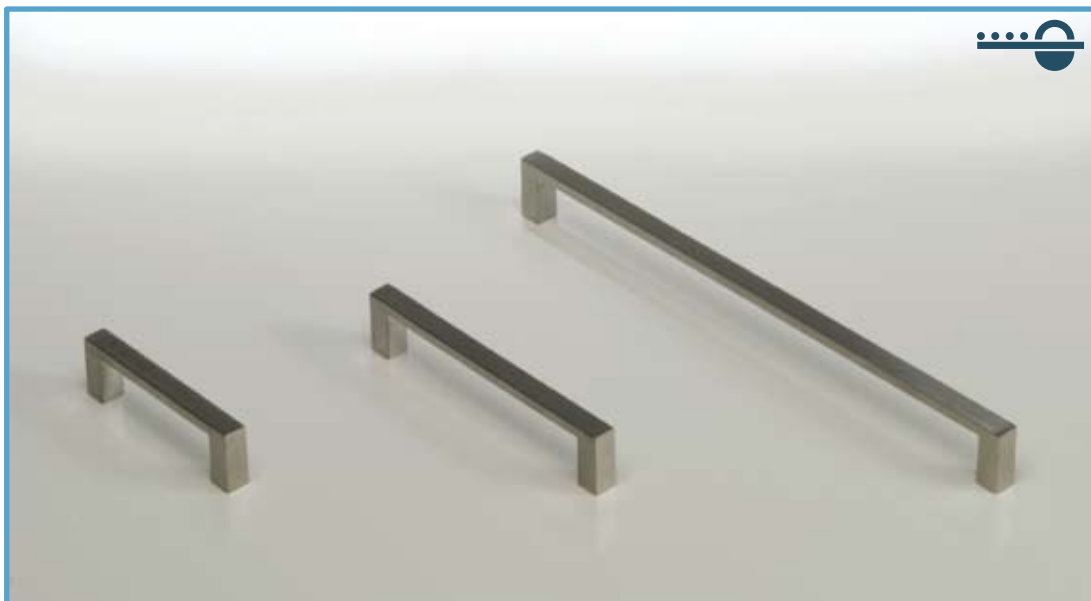

Barben BAC-165



(all dimensions - are in millimetres)

Cabinet Handles

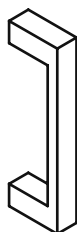

BAC-165/A Section 12x6 /12x12, Proj. 30, Length 100 ctc 88

BAC-165/B Section 12x6 /12x12, Proj. 30, Length 150 ctc 138

BAC-165/C Section 12x6 /12x12, Proj. 30, Length 300 ctc 288

Note: HANDLES can be Manufactured to Specific Requirements



Barben BAC-166



(all dimensions - are in millimetres)

Cabinet Handles



BAC-166/A	Section $\varnothing 10 / 10 \times 3$, Proj. 30, Length 100 ctc 90
BAC-166/B	Section $\varnothing 10 / 10 \times 3$, Proj. 30, Length 150 ctc 140
BAC-166/C	Section $\varnothing 10 / 10 \times 3$, Proj. 30, Length 200 ctc 190
BAC-166/D	Section $\varnothing 10 / 10 \times 3$, Proj. 30, Length 250 ctc 240
BAC-166/E	Section $\varnothing 10 / 10 \times 3$, Proj. 30, Length 300 ctc 290

Note: HANDLES can be Manufactured to Specific Requirements



Barben BAC-175



(all dimensions - are in millimetres)

Cabinet Handles

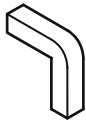

BAC-175/A Square 8, Proj. 30, Length 30



BAC-175/B	Square	8,	Proj. 30,	Length 40	ctc 32
BAC-175/C	Square	8,	Proj. 30,	Length 104	ctc 96
BAC-175/D	Square	10,	Proj. 30,	Length 138	ctc 128
BAC-175/E	Square	10,	Proj. 30,	Length 170	ctc 160
BAC-175/F	Square	10,	Proj. 30,	Length 230	ctc 220
BAC-175/G	Square	12,	Proj. 30,	Length 300	ctc 288
BAC-175/H	Square	12,	Proj. 30,	Length 340	ctc 328
BAC-175/I	Square	12,	Proj. 30,	Length 364	ctc 352
BAC-175/J	Square	12,	Proj. 30,	Length 440	ctc 428
BAC-175/K	Square	12,	Proj. 30,	Length 540	ctc 528

... NEW PRODUCT 10-09-06 ...

Note: HANDLES can be Manufactured to Specific Requirements

PSS Finish available for Projects Only



Barben BAC-200

SSS

(all dimensions - are in millimetres)

Cabinet Handles

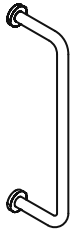

BAC-200/A	Dia. 5, Proj. 32, Length 80 ctc 75
BAC-200/B	Dia. 5, Proj. 32, Length 105 ctc 100
BAC-200/C	Dia. 5, Proj. 32, Length 155 ctc 150
BAC-200/D	Dia. 5, Proj. 32, Length 205 ctc 200

... NEW PRODUCT 10-09-06 ...

Note: HANDLES can be Manufactured to Specific Requirements

PSS Finish available for Projects Only



Barben

BAC-257

SSS

(all dimensions - are in millimetres)

Cabinet Handles



BAC-257/AA Section 25x6, Proj. 30, Length 106 ctc 100

BAC-257/A Section 25x6, Proj. 30, Length 206 ctc 200

BAC-257/B Section 25x6, Proj. 30, Length 306 ctc 300

... NEW PRODUCT 10-09-06 ...

Note: PULLS can be Manufactured to Specific Requirements - "Special Sizes available upon request"

PSS Finish available for Projects Only



Barben

BAC-265

SSS

(all dimensions - are in millimetres)

Cabinet Handles

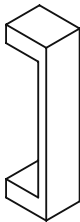

BAC-265/AA	Section 25x6, Proj. 30, Length 112 ctc 100
BAC-265/A	Section 25x6, Proj. 30, Length 212 ctc 200
BAC-265/B	Section 25x6, Proj. 30, Length 312 ctc 300

... NEW PRODUCT 10-09-06 ...

Note: PULLS can be Manufactured to Specific Requirements - "Special Sizes available upon request"

PSS Finish available for Projects Only

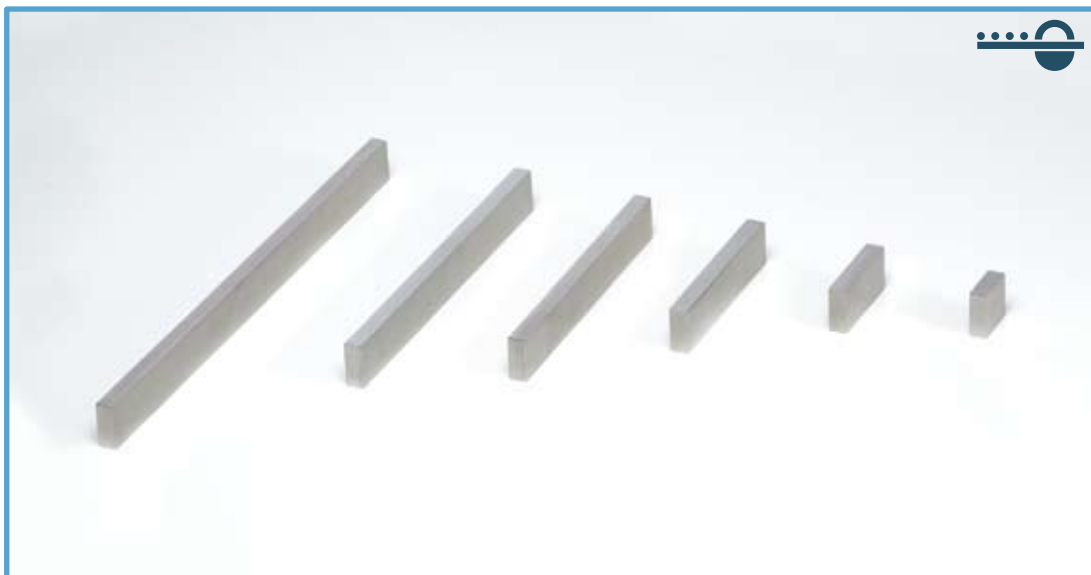

Barben **BAC-BL1**



(all dimensions - are in millimetres)

Cabinet Lip Pulls

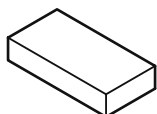

BAC-BL1/AA Section 25x10, Proj. 25, Length 25

BAC-BL1/A Section 25x10, Proj. 25, Length 50

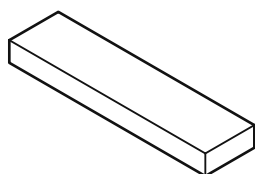

BAC-BL1/B Section 25x10, Proj. 25, Length 100

BAC-BL1/C Section 25x10, Proj. 25, Length 160

BAC-BL1/D Section 25x10, Proj. 25, Length 220

BAC-BL1/E Section 25x10, Proj. 25, Length 300

Note: PULLS can be Manufactured to Specific Requirements - "Special Sized Available upon Request"

PSS Finish available for Projects Only

... **NEW PRODUCT 30-06-04** ...



Barben **BAC-K1**

SSS

(all dimensions - are in millimetres)

Cabinet Knobs



BAC-K1/A Square 10x10 / 7x7, Proj. 17,

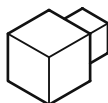

BAC-K1/B Square 16x16 / 10x10, Proj. 26,

Note: KNOBS can be Manufactured to Specific Requirements

PSS Finish available for Projects Only



Barben **BAC-K2 / K3 / K5**



(all dimensions - are in millimetres)

Cabinet Knobs

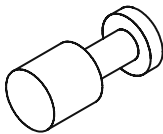

BAC-K2/A

Section $\varnothing 12 \times 12$, $\varnothing 6 \times 12$, $\varnothing 12 \times 3$, Proj. 27,

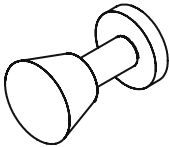

BAC-K3/A

Section $\varnothing 16 \times 10$, $\varnothing 6 \times 12$, $\varnothing 15 \times 3$, Proj. 25,

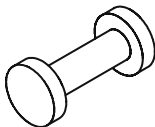

BAC-K5/A

Section $\varnothing 12 \times 3$, $\varnothing 6 \times 19$, $\varnothing 12 \times 3$, Proj. 25,

... NEW PRODUCT 10-09-06 ...

Note: KNOBS can be Manufactured to Specific Requirements

PSS Finish available for Projects Only



Barben **BAC-K8**

SSS

(all dimensions - are in millimetres)

Cabinet Knobs



BAC-K8/A Section $\varnothing 12 \times 25$, Proj. 25



BAC-K8/B Section $\varnothing 16 \times 25$, Proj. 25

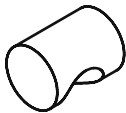

BAC-K8/C Section $\varnothing 19 \times 25$, Proj. 25

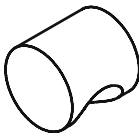

BAC-K8/D Section $\varnothing 25 \times 25$, Proj. 25

... NEW PRODUCT 10-09-06 ...

Note: KNOBS can be Manufactured to Specific Requirements

PSS Finish available for Projects Only



Barben **BAC-K9**



(all dimensions - are in millimetres)

Cabinet Knobs

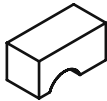

BAC-K9/A Square 12x12, Proj. 25

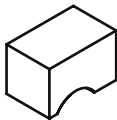

BAC-K9/B Square 16x16, Proj. 25

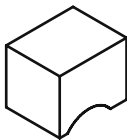

BAC-K9/C Square 20x20, Proj. 25

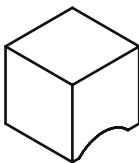

BAC-K/D Square 25x25, Proj. 25

... NEW PRODUCT 10-09-06 ...

Note: KNOBS can be Manufactured to Specific Requirements

PSS Finish available for Projects Only



Barben BAC-LP1



(all dimensions - are in millimetres)

Cabinet Lip Pulls



BAC-LP1/A Section 30x35x15x2, Proj. 30, Length 25

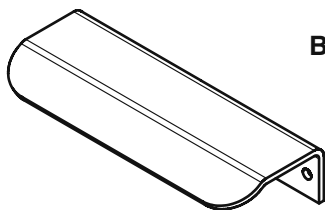

BAC-LP1/B Section 30x35x15x2, Proj. 30, Length 100

BAC-LP1/C Section 30x35x15x2, Proj. 30, Length 200

BAC-LP1/D Section 30x35x15x2, Proj. 30, Length 300

Note: PULLS can be Manufactured to Specific Requirements

PSS Finish available for Projects Only

... **NEW PRODUCT 30-06-04** ...



Barben **BAC-LP2**

SSS

(all dimensions - are in millimetres)

Cabinet Lip Pulls

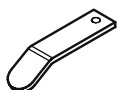

BAC-LP2/A Section 2, Proj. 41, Length 10

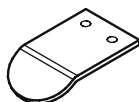

BAC-LP2/B Section 2, Proj. 41, Length 25

Note: PULLS can be Manufactured to Specific Requirements

PSS Finish available for Projects Only



Barben BAC-LP3



(all dimensions - are in millimetres)

Cabinet Lip Pulls

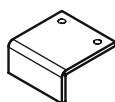

BAC-LP3/A Section 30x15x2, Proj. 30, Length 25

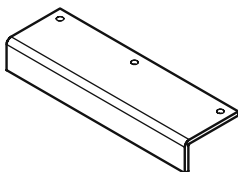

BAC-LP3/B Section 30x15x2, Proj. 30, Length 100

BAC-LP3/C Section 30x15x2, Proj. 30, Length 200

BAC-LP3/D Section 30x15x2, Proj. 30, Length 300

Note: PULLS can be Manufactured to Specific Requirements

PSS Finish available for Projects Only



Barben BAC-LP4

SSS

(all dimensions - are in millimetres)

Cabinet Lip Pulls

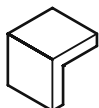

BAC-LP4/A Section 25x25x6, Proj. 25, Length 25

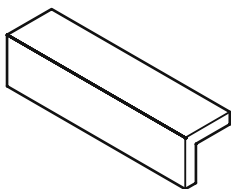

BAC-LP4/B Section 25x25x6, Proj. 25, Length 100

BAC-LP4/C Section 25x25x6, Proj. 25, Length 200

Note: PULLS can be Manufactured to Specific Requirements

PSS Finish available for Projects Only

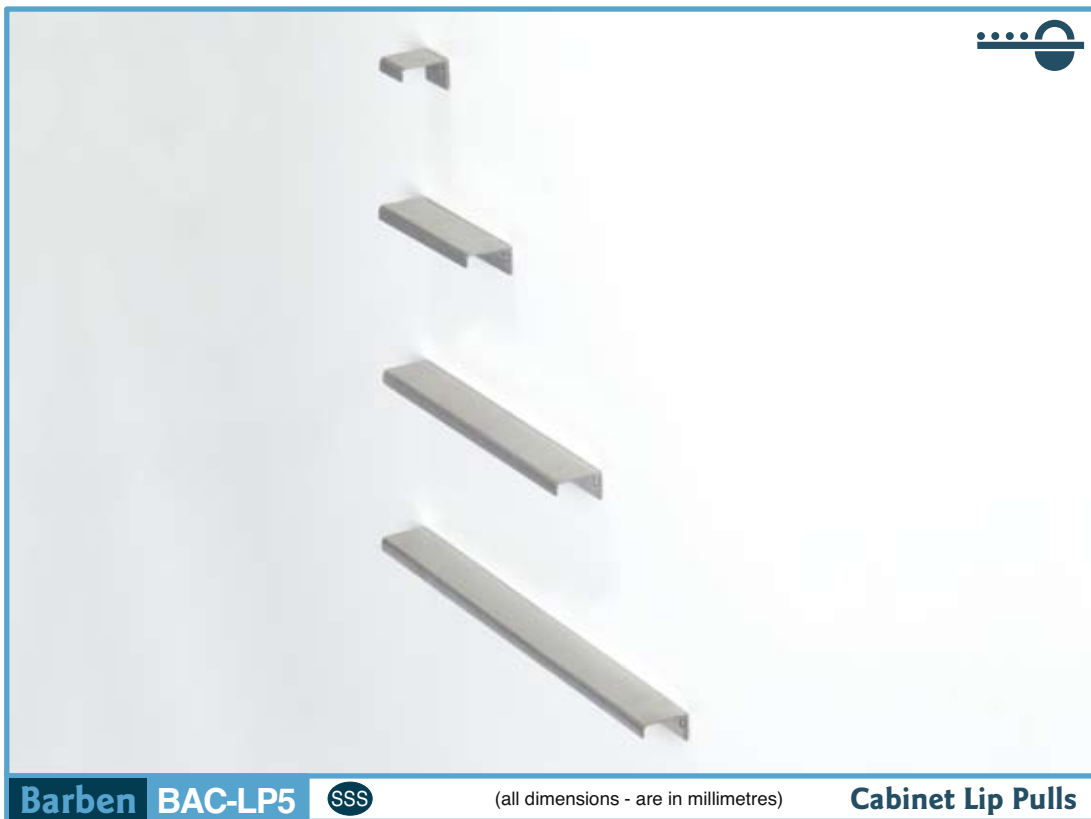

Barben **BAC-LP5**

SSS

(all dimensions - are in millimetres)

Cabinet Lip Pulls

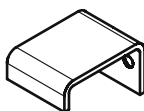

BAC-LP5/A Section 35x20x10x2, Proj. 35, Length 25

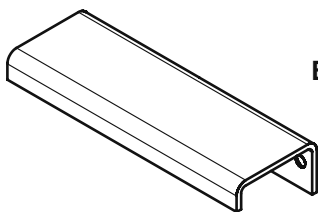

BAC-LP5/B Section 35x20x10x2, Proj. 35, Length 100

BAC-LP5/C Section 35x20x10x2, Proj. 35, Length 200

BAC-LP5/D Section 35x20x10x2, Proj. 35, Length 300

Note: PULLS can be Manufactured to Specific Requirements

PSS Finish available for Projects Only

... NEW PRODUCT 30-06-04 ...



Barben BAC-LP6

SSS

(all dimensions - are in millimetres)

Cabinet Lip Pulls

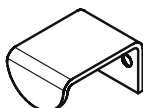

BAC-LP6/A Section 35x20x15x2, Proj. 35, Length 25

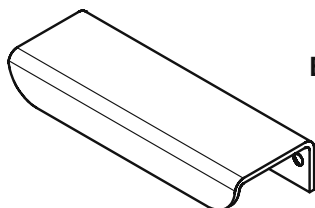

BAC-LP6/B Section 35x20x15x2, Proj. 35, Length 100

BAC-LP6/C Section 35x20x15x2, Proj. 35, Length 200

BAC-LP6/D Section 35x20x15x2, Proj. 35, Length 300

Note: PULLS can be Manufactured to Specific Requirements

PSS Finish available for Projects Only

... NEW PRODUCT 30-06-04 ...



Barben **BAC-RP80 / 50 / 35**

SSS (all dimensions - are in millimetres)

Cabinet Pulls

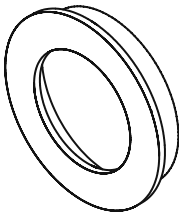

BAC-RP80 Section $\varnothing 80 \times \varnothing 50 \times 3$, $\varnothing 70 \times 11$, Proj. 3

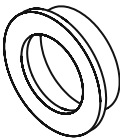

BAC-RP50 Section $\varnothing 50 \times \varnothing 32 \times 3$, $\varnothing 40 \times 11$, Proj. 3



BAC-RP35 Section $\varnothing 35 \times \varnothing 21 \times 3$, $\varnothing 25 \times 11$, Proj. 3

... NEW PRODUCT 10-09-06 ...

Note: RECESSED PULLS can be Manufactured to Specific Requirements

PSS Finish available for Projects Only



Barben BAC-RP150

SSS

(all dimensions - are in millimetres)

Recessed Cabinet Pulls

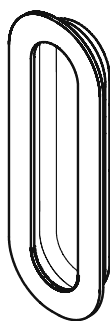

BAC-RP150/O Section 150 x 54 x 2, Proj. 15.5,

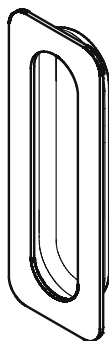

BAC-RP150/R Section 150 x 54 x 2, Proj. 15.5,

Note: PULLS can be Manufactured to Specific Requirements

PSS Finish available for Projects Only

... **NEW PRODUCT 30-06-04** ...



Barben BAC-RP160

SSS

(all dimensions - are in millimetres)

Recessed Cabinet Pulls

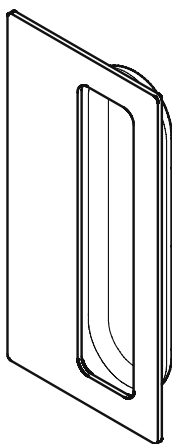

BAC-RP160 Section 150 x 75 x 2, Proj. 15.5,

Note: PULLS can be Manufactured to Specific Requirements

PSS Finish available for Projects Only

... NEW PRODUCT 30-06-04 ...



Barben **BAC-RP170**

SSS

(all dimensions - are in millimetres)

Recessed Cabinet Pulls

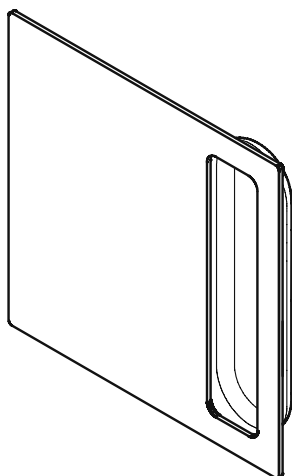

BAC-RP170 Section 150 x 150 x 2, Proj. 15.5,

Note: PULLS can be Manufactured to Specific Requirements

PSS Finish available for Projects Only

... **NEW PRODUCT 30-06-04** ...